

1. Getting to Know Your Radio

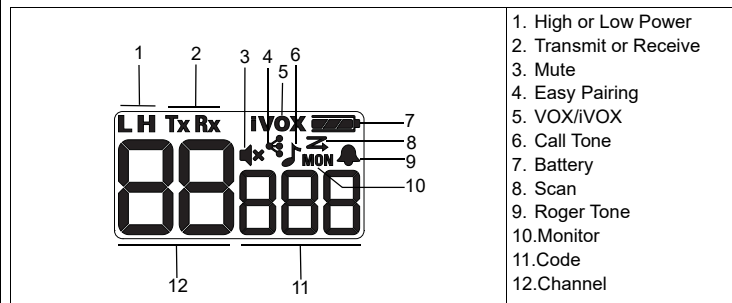
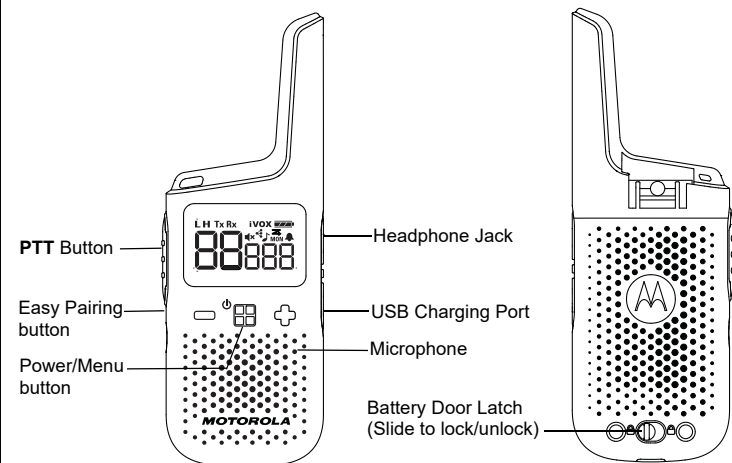

Buttons	Descriptions
Menu/Power	<ul style="list-style-type: none"> Press to enter Menu and scroll through the menu screen. Press and hold for two seconds to turn on or off the radio.
+ and -	<ul style="list-style-type: none"> Press to adjust the volume level. Press to change the settings or trigger action in the menu screen.
PTT	<ul style="list-style-type: none"> Press and hold to talk, release to stop transmission. Press to exit menu screen and return to home screen.
EZ-Pairing	<ul style="list-style-type: none"> Copy channel and code settings from radio A to radio B. Radio B—Hold the button until you hear a beep. The radio is ready to be paired. Multiple radios can be paired simultaneously. Radio A—Hold the button until you hear a double beep. The radio broadcasts channel and code settings for other radios to pair.

Additional Information

Internal Voice Operated Transmission (iVOX)/Voice Operated Transmission (VOX)

The microphone detects if you are talking when using VOX. If you are talking, the radio triggers transmission automatically.

- When iVOX is displayed, the radio uses the built-in microphone to detect your voice.
- When a VOX headset is connected to the radio, VOX is displayed and the headset microphone is used to detect your voice.

You can turn off or select the following settings to select the sensitivity level.

L3	High Sensitivity for quiet environments. Speaking softly is enough to trigger VOX transmission.
L2	Medium Sensitivity for most environments
L1	Low Sensitivity for noisy environments. You must speak up to trigger VOX transmission.

Note: Pressing the PTT button cancels the VOX transmission.



MN006042A01-AD

2. Setting up Your Radio

Installing and Charging the Battery

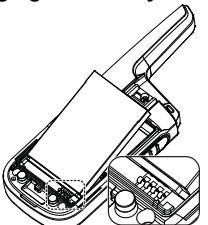

- Observe the polarity before installing the battery.
 - Charge the battery using the desktop charger or USB. Charging is completed when the battery icon on the radio stops blinking. Charging takes up to 8 hours.
- Note: Connect the USB charger to a nearby and easily accessible wall power outlet.

Inserting and Removing Belt

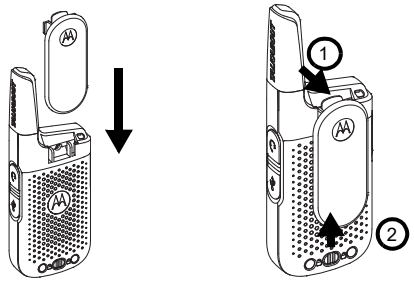

Turning your Radio On and Off

To turn the radio on or off, hold the Power/Menu button until the display turns on or off.

Channel and Codes

- Set your radios with the same channel and code setting to enable communication with other radios.
- The H/L (High/Low) icon is part of the Channel Number. Ensure all radios in your group show the same H/L icon.
- The channel setting controls the radio frequency. To avoid jamming, select a channel that is not used by others in your area. See table in Section 3, "Scan" for more information on selecting unused channel.
- The code setting on the transmitting and receiving radios need to match, otherwise the receiving radio blocks the received signal. This feature helps you to mute unwanted voices from other radio users transmitting on your channel.
- When code is set to zero, radio does not block any signal and everything that is picked up on the channel is sent to the speaker. Motorola Solutions recommends setting your code to zero when using T38 with radios that do not support the code feature. See Section 3, "Navigating the Menu Pages" for detailed instructions on how to change settings.
- Channel and code settings can be copied from one radio to multiple radios simultaneously with a shortcut feature called Easy-Pairing. See table in Section 1, "EZ-Pairing" for instruction on how to copy channel and code settings.

Call Tone

When you send a Call Tone, the receiving radio sounds a tone similar to phone ringing tone.

Scan

Radio scans for voice activity by cycling through the channels. When signals are detected, the signal is sent to the speaker. This feature allows you to find which channel is being used by other groups and have heavy traffic. This helps you to avoid the busy channels when deciding which channel to use for your group.

Monitor

You can hear everything including noise on your current radio channel. This feature allows you to monitor a channel for weak signals.

Roger Tone

This feature adds a beep to mark the end of a transmission when you release the PTT button. When the receiver hears the roger tone, it is a confirmation that complete message has been received.

Weatherproof

This radio is weatherproof to IP54 standards. The radio is resistant to occasional splash of water only when the battery and connector covers are sealed. Do not expose the radio to water for extended period of time. Do not submerge the radio in water.

3. Navigating the Menu Pages

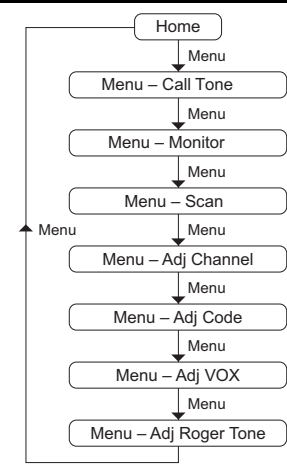

Use the Menu button to scroll through the menu screen. Press PTT to exit any screen and return to home screen.

Menu Screen	Use the + or - button to perform the following actions:
Call Tone 	Start or stop Call Tone transmission.
Monitor MON	Start or stop monitoring the air-wave. You can hear signals transmitted on the channel setting of your radio. If there is no signal, you can hear static. Press + or - button to monitor and release to stop. After a few seconds of monitoring, you hear a beep sound. After the beep sound, radio continues to monitor even if you release the button. To stop monitoring, press + or - again.
Scan 	Start or stop scanning the air-wave. Radio scans all the channels one after another. When a signal is detected, you hear the signal on the speaker and the radio displays the channel of the detected signal.
Adjust VOX VOX/iVOX	To change the Voice Operated Transmission (VOX) setting, select OFF or L1 to L3. L3 being the most sensitive, use it in quiet environments.
Adjust Roger Tone 	Enable or disable the roger tone. Roger tone is a beep tone that you hear when PTT is released.
Adjust Channel (Channel number blinks)	Change the radio channel setting.
Adjust Code (Code number blinks)	Change the radio code setting.

Battery Information

The rated battery life is measured under industrial standard 5-5-90 duty cycle under lab conditions. (5% of the time transmitting, 5% receiving with speaker on, 90% waiting for incoming call.)

Battery Capacity Maintenance

The T38 radio comes equipped with a rechargeable Li-Ion battery. This battery should be fully charged before initial use to ensure optimum capacity and performance. Battery life is determined by several factors. Among the more critical are the regular overcharge of batteries and the average depth of discharge with each cycle. Typically, the greater the overcharge and the deeper the average discharge, the fewer cycles a battery will last. For example, a battery which is overcharged and discharged 100 % several times a day, lasts fewer cycles than a battery that receives less of an overcharge and is discharged to 50 % per day. Further, a battery which receives minimal overcharging and averages only 25 % discharge, lasts even longer. Turn off the radio while charging.

Push-to-Talk Time-out Timer

To avoid air-wave traffic congestion, transmission ends after one minute even if the PTT button is still pressed. To reset the timer, release the PTT button briefly.

4. Using Your Radio

Talking/Transmitting

- Press and hold the PTT button, then start talking into the microphone.
- Release the PTT button to stop transmission.

Note: Do not press the PTT button when others are talking. When more than one radio transmits on the same channel, the air-wave is jammed and all transmissions are lost.

Listening/Receiving

- The radio speaker receives signal automatically if radio is set to the same channel and code as the transmitting radio.
- Ensure the speaker volume is set to an appropriate level.

Adjusting Speaker Volume

- Press + or - from the home screen.

Using Headsets

- When a headset is connected to the radio, radio speaker is disabled. You need to wear headset to monitor and receive messages.
- If your headset has PTT button, you can use the button to make a transmission with the microphone on the headset.
- You can still use the PTT button on the radio to make a transmission with the microphone on the radio.

Channel and Frequencies

Channel	Frequency (MHz)	Channel	Frequency (MHz)
1	462.5625	14	467.5625
2	462.5750	15	467.5750
3	462.5875	16	467.5875
4	462.6000	17	467.6000
5	462.6125	18	467.6125
6	462.6250	19	467.6250
7	462.6375	20	467.6375
8	462.6500	21	467.6500
9	462.6625	22	467.6625
10	462.6750	23	467.6750
11	462.6875	24	467.6875
12	462.7000	25	467.7000
13	462.7125	26	467.7125



Safety and General Information

Caution

Before using this radio, read this booklet which contains important operating instructions.

For information on product details, brochures, user manuals and approved accessories, please refer to www.motorolasolutions.com.

Compliance with RF Exposure Standards

National and international regulations require manufacturers to comply with the RF energy exposure limits for portable two-way radios before they can be marketed. Your Motorola Solutions two-way radio is designed, manufactured, and tested to comply with all applicable national and international regulations for human exposure to radio frequency electromagnetic energy.

RF Energy Exposure Awareness and Control Information and Operational Instructions for General Population and Uncontrolled Environment Use

For more information on what RF energy exposure is, see the following websites:

- <https://www.fcc.gov/>
- <http://www.who.int/peh-emf/project/en/>
- <http://www.ic.gc.ca/eic/site/smt-gst.nsf/eng/sf11467.html>
- <http://www.ic.gc.ca/eic/site/smt-gst.nsf/eng/sf01904.html>

Operating Instructions

- Transmit no more than 50% of the time. To transmit (talk), press the **Push-To-Talk (PTT)** button. To receive calls, release the **PTT** button.
- Hold the radio in a vertical position in front of the face with the microphone (and other parts of the radio including the antenna) at least 1 in. (2.5 cm) away from the nose or lips. Antenna should be kept away from the eye.
- When worn on the body, always place the radio in a Motorola Solutions-approved clip, holder, holster, case, or body harness for this product.
- DO NOT hold the antenna when the radio is transmitting.
- DO NOT use any portable radio that has a damaged antenna. If a damaged antenna comes into contact with your skin, a minor burn can result.
- To ensure continued compliance with applicable RF exposure limits, use only Motorola Solutions-approved, supplied or replacement antennas, batteries, and accessories.
- For a list of Motorola Solutions-approved accessories please refer to your user manual or visit www.motorolasolutions.com

Acoustic Safety

Exposure to loud noises from any source for extended periods of time may temporarily or permanently affect your hearing. The louder the volume of the radio, the sooner your hearing will be affected. Hearing damage from loud noise is sometimes undetectable at first, and can have a cumulative effect.

To protect your hearing, follow these precautions:

- Use the lowest volume necessary to do your job.
- Turn up the volume only if you are in noisy surroundings.
- Turn down the volume before putting on a headset or headphones.
- Limit the amount of time you use a headset or headphones at high volume.
- When using the radio without a headset or headphones, do not place the speaker of the radio directly against your ear.

Medical Devices

If you use a personal medical device, such as a pacemaker or hearing aid, consult the manufacturer of your device to determine if it is adequately shielded from RF energy. Your physician may be able to assist you in obtaining this information.

Holsters Incorporating Magnets

Motorola Solutions holsters incorporate strong, neodymium magnets. If you use a personal medical device, such as a pacemaker or hearing aid, consult the manufacturer of your device to determine if it can be used in close proximity to magnets. Your physician may be able to assist you in obtaining this information. Also be aware that magnets can damage other products, including cell phones, computers, hard drives, and other electronic devices, as well as credit cards and magnetic media. Keep the holster away from any mechanical device that could be affected by a magnetic field. Consult the manufacturer of your product to determine if your device or product can be used in close proximity to magnets.

Operational Warnings

The following explains the operational warnings:

For Vehicle With Air Bags

 WARNING	Warning: <ul style="list-style-type: none">• Refer to vehicle manufacturer's manual prior to installation of electronic equipment to avoid interference with air bag wiring.• DO NOT place a portable radio in the area over an air bag or in the air bag deployment area. Air bags inflate with great force. If a portable radio is placed in the air bag deployment area and the air bag inflates, the radio may be propelled with great force and cause serious injury to occupants of the vehicle.
---	--

Potentially Explosive Atmospheres

 WARNING	Warning: <ul style="list-style-type: none">• Do not carry a radio that is not certified for Hazardous Locations into a potentially explosive atmosphere. It could result in a serious injury or death. You should only use a radio certified for hazardous locations in potentially explosive atmospheres.• Explosive atmospheres refer to hazard classified locations that may contain hazardous gas, vapors, dusts, such as fueling areas below decks on boats, fuel or chemical transferor storage facilities, and areas where the air contains chemicals or particles such as grain, dust or metal powders. Areas with potentially explosive atmospheres are often, but not always, posted.• DO NOT remove, install, or charge batteries in such areas, or remove or install antennas. Sparks in a potentially explosive atmosphere can cause an explosion or fire resulting in bodily injury or even death.
---	---

Blasting Caps and Blasting Areas

 WARNING	Warning: To avoid possible interference with blasting operations, turn off your radio when you are near electrical blasting caps, in a blasting area, or in areas posted: "Turn off two-way radio." Obey all signs and instructions.
---	---

Batteries

- **Caution:** Use only Motorola Solutions approved batteries. Risk of explosion if the battery is replaced by an incorrect type.
- Charge your battery using the approved Motorola Solutions charger.
- Use the battery in accordance with its water and/or dust Ingress Protection (IP) rating.
- Do not discard your battery into a fire.
- Do not replace the battery in any area labeled "Hazardous Atmosphere".
- Do not disassemble, crush, puncture, shred, or otherwise attempt to change the form of your battery.
- Do not dry a wet or damp battery with an appliance or heat source, such as a hair dryer or microwave oven.
- Do not allow conductive material such as jewelry, keys, or beaded chains to touch exposed battery terminals.
- Do not dispose of batteries with household waste.

Safety Instruction for Power Supply

1. The power supply is for use with equipment according to IEC/EN/UL 62368-1/60950-1.
2. The power supply is for indoor use in dry locations.

3. The equipment should be connected to a nearby and easily accessible socket outlet.
4. If the power supply is damaged or defective, do not repair or use the power supply.

Do Not Substitute Options or Accessories

The Motorola Solutions communications equipment certified as intrinsically safe by the approving agency (FM, UL, CSA, CENELEC) is tested as a complete system which consists of the listed agency approved portable, approved battery, and approved accessories or options, or both. This approved portable and battery combination must be strictly observed. There must be no substitution of items, even if the substitute has been previously approved with a different Motorola Solutions communications equipment unit. Approved configurations are listed by the approving agency (FM, UL, CSA, CENELEC).

The Intrinsically Safe Approval Label affixed to radio refers to the intrinsically safe classification of that radio product, and the approved batteries that can be used with that system.

The manual PN referenced on the Intrinsically Safe Approval Label identifies the approved accessories and or options that can be used with that portable radio unit. Using a non-Motorola Solutions-intrinsically safe battery and/or accessory with the Motorola Solutions-approved radio unit will void the intrinsically safe approval of that radio unit.

European Union (EU) Waste of Electrical and Electronic Equipment (WEEE) Directive

 WEEE	The European Union's WEEE directive requires that products sold into EU countries must have the crossed out trash bin label on the product (or the package in some cases). As defined by the WEEE directive, this cross-out trash bin label means that customers and end-users in EU countries should not dispose of electronic and electrical equipment or accessories in household waste. Customers or end-users in EU countries should contact their local equipment supplier representative or service center for information about the waste collection system in their country.
--	---

 WEEE	For Brazil, information for disposal and recycling of electronic waste, batteries, and packaging, please call: 0800168272
--	---

Licensing Information

Brazil

It is not required to use license in Brazil. See the Anatel site for more information: <http://www.anatel.gov.br>.

Use of this radio outside the country where it was intended to be distributed is subject to government regulations and may be prohibited.

Radio 462 - 467 MHz

This equipment has no rights to the protection against harmful interference and it cannot cause interferences to the duly authorized systems.

SAR

This device is homologated by Anatel according the regulatory procedures to compliance evaluate for telecommunications devices and it attends to the technical requirements applied,

including the Specific Absorption Rate exposition limits related to the electrical fields, magnetic and electromagnetic of radio frequency. The maximum SAR values measured for this device are: 0,1380 W/Kg (Head) and 0,3430 W/Kg (Body).

Warranty

Consumer Two-Way Radio Products and Accessories purchased in Brazil

What Does this Warranty Cover?

Subject to the exclusions contained below, Motorola Solutions, Inc. ("Motorola") warrants the Motorola branded consumer two-way radios that operate via Family Radio Service or General Mobile Radio Service ("Products"), the Motorola branded or certified accessories sold for use with these Products ("Accessories") to be free from defects in materials and workmanship under normal consumer usage for the period(s) outlined below. This limited warranty is the exclusive remedy of a consumer, and applies as follows to new Products and Accessories and purchased by consumers in Brazil, which are accompanied by this written warranty:

Who is Covered?

This warranty extends only to the first consumer purchaser, and is not transferable.

What will MOTOROLA SOLUTIONS, INC. do?

Motorola Solutions, Inc., at its option, will at no charge repair, replace or refund the purchase price of any Products or Accessories that do not conform to this warranty. We may use functionally equivalent reconditioned/refurbished/pre-owned or new Products or Accessories.

What Other Limitations Are There?

Any Implied Warranties, Including Without Limitation

The implied warranties of merchantability and fitness for a particular purpose, shall be limited to the duration of this limited warranty, otherwise the repair, replacement, or refund as provided under this express limited warranty is the exclusive remedy of the consumers, and is provided in lieu of all other warranties, express or implied. In no event shall Motorola Solutions be liable, whether in contract or tort (including negligence) for damages in excess of the purchase price of the product or accessory, or for any indirect, incidental, special or consequential damages of any kind, or loss of revenue or profits, loss of business, loss of information or other financial loss arising out of or in connection with the ability or inability to use the products or accessories to the full extent these damages may be disclaimed by law.

Some states and jurisdictions do not allow the limitation or exclusion of incidental or consequential damages, or limitation on the length of an implied warranty, so the above limitations or exclusions may not apply to you. This warranty gives you specific legal rights, and you may also have other rights that vary from state to state or from one jurisdiction to another.

Brazil

Products Covered	Length Of Coverage
Products and Accessories as defined above, unless otherwise provided for below.	One (1) year from the date of purchase by the first consumer purchaser of the product unless otherwise provided for below.
Batteries whose fully charged capacity falls below 80% of their rated capacity and batteries that leak.	
Products and Accessories that are repaired or replaced.	The balance of the original warranty or for ninety (90) days from the date returned to the consumer, whichever is longer.

Exclusions From Warranty Coverage

Normal Wear and Tear: Periodic maintenance, repair and replacement of Products or Accessories due to normal wear and tear.

Abuse & Misuse:

Defects or damage that result from: (a) improper operation, storage, misuse or abuse, accident or neglect, such as physical damage (cracks, scratches, etc.) to the surface of the Products and Accessories resulting from misuse; (b) contact with liquid, water, rain, extreme humidity or heavy perspiration, sand, dirt or the like, extreme heat, or food; (c) use of the Products or Accessories for commercial purposes or subjecting the Product or Accessory to abnormal usage or conditions; or (d) other acts which are not the fault of Motorola Solutions.

Use of Non-Motorola Solutions branded Products and Accessories:

Defects or damage that result from the use of Non-Motorola Solutions branded or certified products, accessories, software or other peripheral equipment.

Unauthorized Service or Modification:

Defects or damages resulting from service, testing, adjustment, installation, maintenance, alteration, or modification in any way by someone other than Motorola Solutions or its authorized service centers.

Altered Products:

Products or Accessories with (a) serial numbers or date tags that have been removed, altered or obliterated; (b) broken seals or that show evidence of tampering; (c) mismatched board serial numbers; or (d) nonconforming or non-Motorola Solutions branded housings, or parts.

Communication Services:

Defects, damages, or the failure of Products or Accessories due to any communication service or signal you may subscribe to or use with the Products or Accessories.

1. Sobre o rádio

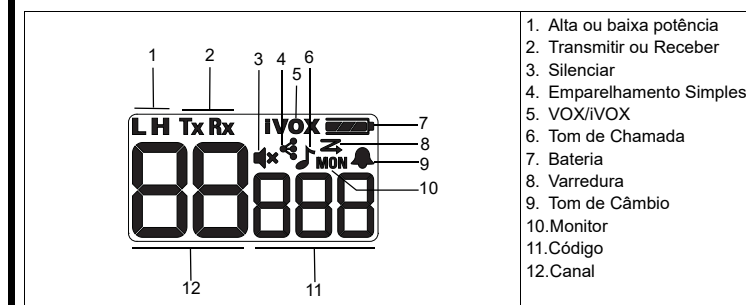
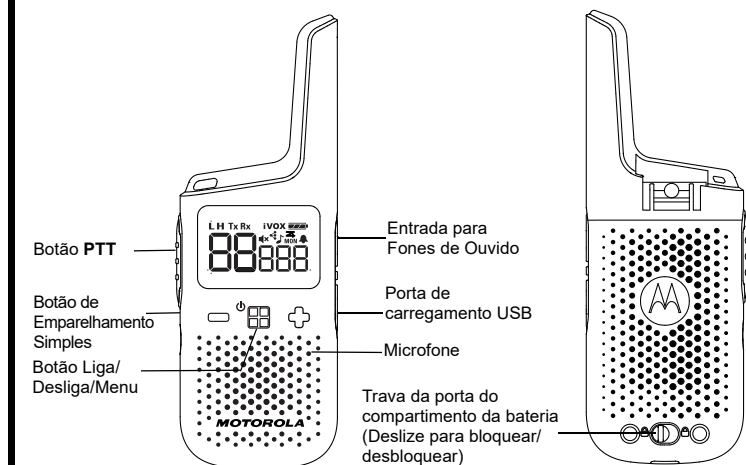

Botões	Descrições
Menu/Power	<ul style="list-style-type: none"> Pressione para acessar o Menu e percorrer a tela de menu. Pressione e segure o botão por dois segundos para ligar ou desligar o rádio.
⊕ e ⊖	<ul style="list-style-type: none"> Pressione para ajustar o nível de volume. Pressione para alterar as configurações ou o acionador na tela de menu.
PTT	<ul style="list-style-type: none"> Pressione e segure o botão para falar e solte para parar a transmissão. Pressione para sair da tela do menu e retornar à tela inicial.
Emparelhamento EZ	<p>Copie configurações de canal e de código do rádio A para o rádio B.</p> <ol style="list-style-type: none"> Rádio B – Segure o botão até ouvir um bipe. O rádio está pronto para ser emparelhado. Vários rádios podem ser emparelhados simultaneamente. Rádio A – Segure o botão até ouvir um bipe duplo. O rádio transmite configurações de canal e de código para outros rádios a serem emparelhados.

2. Como configurar seu rádio

Instalação e carregamento da bateria

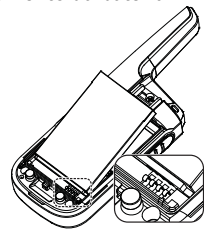

- Observe a polaridade antes de instalar a bateria.
- Carregue a bateria usando o carregador de mesa ou o cabo USB. O carregamento é concluído quando o ícone da bateria no rádio para de piscar. O carregamento leva até 8 horas.

Nota: Conecte o carregador USB a uma tomada de parede próxima e de fácil acesso.

Inserção e remoção do cinto

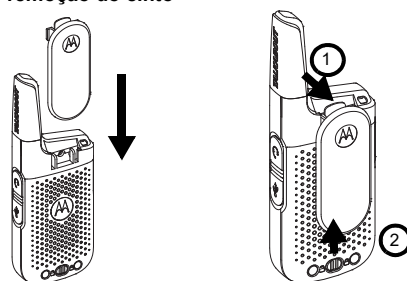

Como ligar e desligar o rádio

Para ligar ou desligar o rádio, mantenha o botão Liga/Desliga/Menu pressionado até que a tela seja ligada ou desligada.

Canal e códigos

- Defina seus rádios com a mesma configuração de canal e de código para permitir a comunicação com outros rádios.
- O ícone H/L (Alto/Baixo) faz parte do número do canal. Certifique-se de que todos os rádios do seu grupo mostrem o mesmo ícone H/L.
- A configuração do canal controla a frequência de rádio. Para evitar congestionamentos, selecione um canal que não seja usado por outras pessoas em sua área. Consulte a tabela na Seção 3, "Verificação", para obter mais informações sobre a seleção de canal não usado.
- A configuração do código nos rádios transmissores e receptores precisa ter correspondência. Caso contrário, o rádio receptor bloqueia o sinal recebido. Este recurso ajuda a silenciar vozes indesejadas de outros usuários de rádio que estiverem fazendo transmissão em seu canal.
- Quando o código está definido como zero, o rádio não bloqueia o sinal e tudo o que é coletado no canal é enviado para o alto-falante. A Motorola Solutions recomenda configurar seu código como zero ao usar o T38 com rádios que não são compatíveis com o recurso de código. Consulte a Seção 3, "Navegação no menu Páginas" para obter instruções detalhadas sobre como alterar as configurações.
- As configurações de canal e de código podem ser copiadas de um rádio para vários rádios simultaneamente com um recurso de atalho chamado Emparelhamento Simples. Consulte a tabela na Seção 1, "Emparelhamento EZ" para obter instruções sobre como copiar configurações de canal e de código.

Tom de Chamada

Ao enviar um tom de chamada, o rádio receptor emite um som semelhante ao tom de toque do telefone.

Varredura

O rádio verifica atividade de voz, percorrendo os canais. Quando os sinais são detectados, o sinal é enviado para o alto-falante. Este recurso permite localizar canais que estão sendo usados por outros grupos e com tráfego intenso. Isso ajuda a evitar canais ocupados ao decidir qual canal usar para o grupo.

Monitor

É possível ouvir tudo, inclusive ruídos no canal de rádio atual. Este recurso permite monitorar um canal para buscar sinais fracos.

Tom de Câmbio

Este recurso adiciona um bipe para marcar o fim de uma transmissão ao soltar o botão PTT. Quando o receptor ouve o tom de câmbio, esse tom é uma confirmação de que a mensagem completa foi recebida.

Resistente a intempéries

Este rádio é à prova de intempéries de acordo com os padrões IP54. O rádio é resistente a respingos de água ocasionais somente quando a bateria e as tampas do conector são vedadas. Não exponha o rádio à água por um período prolongado. O rádio não deve ser submerso em água.

3. Como navegar pelas páginas do menu

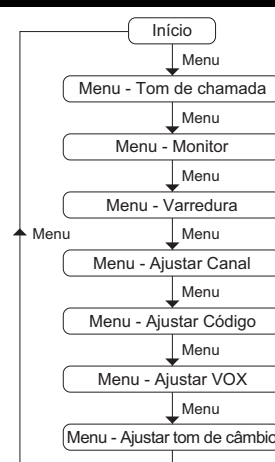

Use o botão **Menu** para percorrer a tela de menu. Pressione o botão **PTT** para sair de qualquer tela e retornar à tela inicial.

Tela de Menu	Use o botão ⊕ ou ⊖ para executar as seguintes ações:
Tom de Chamada	Iniciar ou parar a transmissão do tom da chamada.
Monitor MON	Iniciar ou parar o monitoramento de onda por ar. É possível ouvir sinais transmitidos na configuração de canal do rádio. Se não houver sinal, é possível ouvir o ruído estático. Pressione o botão ⊕ ou ⊖ para monitorar e solte para parar. Após alguns segundos de monitoramento, você ouvirá um som de bipe. Após o som de bipe, o rádio continua a monitorar até mesmo se você soltar o botão. Para interromper o monitoramento, pressione ⊕ ou ⊖ novamente.
Varredura Z	Inicie ou pare a verificação da onda por ar. O rádio verifica todos os canais um após o outro. Quando um sinal é detectado, você ouve o sinal no alto-falante e o rádio exibe o canal do sinal detectado.
Ajustar VOX VOX/iVOX	Para alterar a configuração da transmissão operada por voz (VOX), selecione DESLIGADO ou L1 a L3. Como o L3 é o mais sensível, use-o em ambientes silenciosos.
Ajustar tom de câmbio	Ative ou desative o tom de câmbio. O tom de câmbio é um tom de bipe que se ouve quando o botão PTT é liberado.
Ajustar canal (Número do canal pisca)	Altere a configuração do canal de rádio.
Ajustar código (Número do código pisca)	Altere a configuração do código de rádio.

Informações sobre a Bateria

A duração da bateria é medida de acordo com o padrão do setor para ciclo de trabalho 5-5-90 sob condições de laboratório. (5 % do tempo de transmissão, 5 % de recebimento com alto-falante, 90 % de espera por recebimento de chamada.)

Manutenção de Capacidade da Bateria

O rádio T38 vem com uma bateria de Íons de Lítio recarregável. Essa bateria deve ser completamente carregada antes do primeiro uso para garantir o máximo de capacidade e desempenho. A duração da bateria é determinada por diversos fatores. Entre os mais importantes, estão a sobrecarga regular das baterias e a profundidade média de descarga com cada ciclo. Normalmente, quanto maior a sobrecarga e mais profunda a descarga média, menos ciclos a bateria durará. Por exemplo, uma bateria que é sobrecarregada e descarregada 100 % diversas vezes ao dia dura menos ciclos do que uma bateria que recebe menos de uma sobrecarga e descarregada para 50 % por dia. Além disso, uma bateria que recebe sobrecarga mínima e uma média de descarga de somente 25 % dura ainda mais. Desligue o rádio ao carregar.

Timer de tempo limite do push-to-talk

Para evitar congestionamento do tráfego da onda por ar, a transmissão termina após um minuto, mesmo se o botão PTT ainda estiver pressionado. Para redefinir o timer, solte o botão PTT rapidamente.

4. Como usar o rádio

Falar/Transmitir

- Mantenha pressionado o botão PTT e comece a falar ao microfone.
- Solte o botão PTT para parar a transmissão.

Nota: Não pressione o botão PTT quando outras pessoas estiverem falando. Quando mais de um rádio transmite no mesmo canal, a onda por ar fica congestionada e todas as transmissões são perdidas.

Escutar/Receber

- O alto-falante do rádio recebe sinal automaticamente se o rádio estiver configurado para o mesmo canal e código que o rádio transmissor.
- Verifique se o volume do alto-falante está definido em um nível apropriado.

Como ajustar o volume do alto-falante

- Pressione ⊕ ou ⊖ na tela inicial.

Usar fones de ouvido

- Quando um fone de ouvido é conectado ao rádio, o alto-falante do rádio é desativado. Você precisa usar o fone de ouvido para monitorar e receber mensagens.
- Se o seu fone de ouvido tiver o botão PTT, é possível usar o botão para fazer uma transmissão com o microfone do fone de ouvido.
- Você ainda pode usar o botão PTT no rádio para fazer uma transmissão com o microfone do rádio.

Canal e frequências

Canal	Frequência (MHz)	Canal	Frequência (MHz)
1	462.5625	14	467.5625
2	462.5750	15	467.5750
3	462.5875	16	467.5875
4	462.6000	17	467.6000
5	462.6125	18	467.6125
6	462.6250	19	467.6250
7	462.6375	20	467.6375
8	462.6500	21	467.6500
9	462.6625	22	467.6625
10	462.6750	23	467.6750
11	462.6875	24	467.6875
12	462.7000	25	467.7000
13	462.7125	26	467.7125

Informações Adicionais

Transmissão operada por voz interna (iVOX)/Transmissão operada por voz (VOX)

O microfone detecta se você está falando ao usar o VOX. Se você estiver falando, o rádio acionará a transmissão automaticamente.

- Quando o iVOX é exibido, o rádio usa o microfone integrado para detectar sua voz.
- Quando um fone de ouvido VOX está conectado ao rádio, o VOX é exibido e o microfone do fone de ouvido é usado para detectar sua voz.

É possível desativar ou selecionar as configurações a seguir para selecionar o nível de sensibilidade.

L3	Alta sensibilidade para ambientes silenciosos. Falar com voz suave é suficiente para acionar a transmissão VOX.
L2	Sensibilidade média para a maioria dos ambientes
L1	Baixa sensibilidade para ambientes ruidosos. Você deve falar para acionar a transmissão VOX.

Nota: o pressionamento do botão PTT cancela a transmissão VOX.



MN006042A01-AD



