

TALKABOUT™ TWO-WAY RADIO T39D USER GUIDE



MN010571A01-AA

MOTOROLA, MOTO, MOTOROLA SOLUTIONS and the Stylized M logo are trademarks or registered trademarks of Motorola Trademark Holdings, LLC and are used under license. All other trademarks are the property of their respective owners. © 2024 Motorola Solutions, Inc. All Rights Reserved.

Printed in

English

Radio Overview

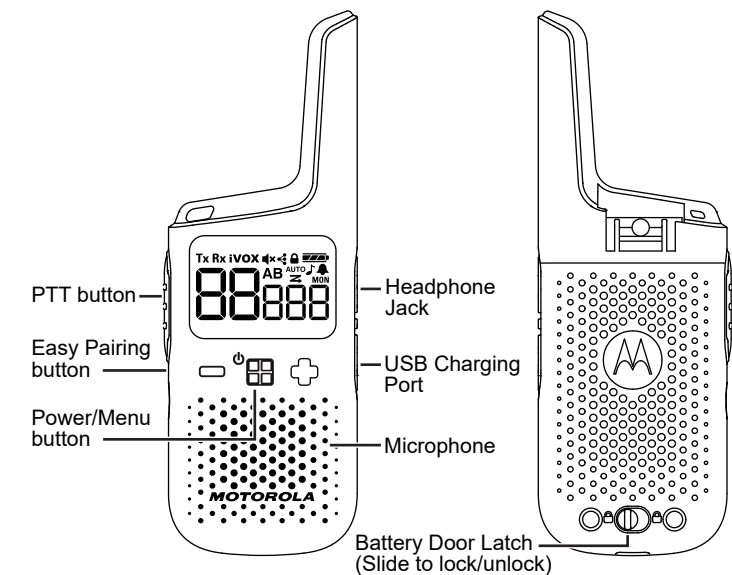

Icons	Descriptions
	<ol style="list-style-type: none"> 1. Transmit or Receive 2. VOX/iVOX 3. Mute 4. Easy Pairing 5. Lock 6. Battery 7. Time Slot 8. Auto Call Tone 9. Call Tone 10. Roger Tone 11. Scan 12. Monitor 13. Color Code 14. Channel

Buttons	Descriptions
Menu/Power	<ul style="list-style-type: none"> Press to enter Menu and scroll through the menu screen. Press and hold for two seconds to turn on or off the radio.
+ and -	<ul style="list-style-type: none"> Press to adjust the volume level. Press to change the settings or trigger action in the menu screen.
PTT	<ul style="list-style-type: none"> Press and hold to talk, release to stop transmission. Press to exit menu screen and return to home screen.
Easy Pairing	<p>Copy the channel and sub code settings from Radio A to Radio B.</p> <ol style="list-style-type: none"> 1. Radio B—Hold the button until you hear a beep. The radio is ready to be paired. Multiple radios can be paired simultaneously. 2. Radio A—Hold the button until you hear a double beep. The radio broadcasts channel and code settings for other radios to pair.

Radio Set-Up

Installing and Charging Batteries

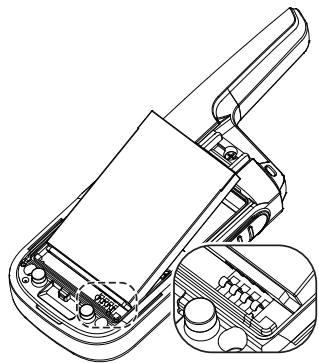

1. Before installing the batteries, observe the polarity.
2. Charge the battery by using the desktop charger or USB. Charging is complete when the battery icon on the radio stops blinking. Charging takes up to 8 hours.

Inserting and Removing the Belt Clip

- To insert or remove the belt clip, refer to the following images:

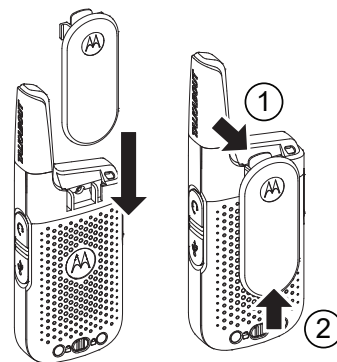

Turning the Radio On and Off

- To turn the radio on or off, press and hold the **Power/Menu** button. The LCD display turns on or off.

Channels, Time Slot, and Color Code

- Set your radios with the same channel, time slot, and color code setting to enable communication with other radios.
- The channel and time slot settings control the radio frequency and timing. To avoid jamming, select a channel and time slot that is not used by others in your area. See **Scan** on page 1 for more information on selecting unused channel.
- The color code setting on the transmitting and receiving radios need to match, otherwise the receiving radio blocks the received signal. This feature helps you to mute unwanted voices from other radio users transmitting on your channel.
- Channel, time slot, and color code settings can be copied from one radio to multiple radios simultaneously with a shortcut feature called Easy Pairing. See **Radio Overview** on page 1 for instruction on ways to copy channel and code settings.

Navigating the Menu Pages

1. Use the **Menu** button to scroll through the menu options.
2. Press the **PTT** button to return to home screen.

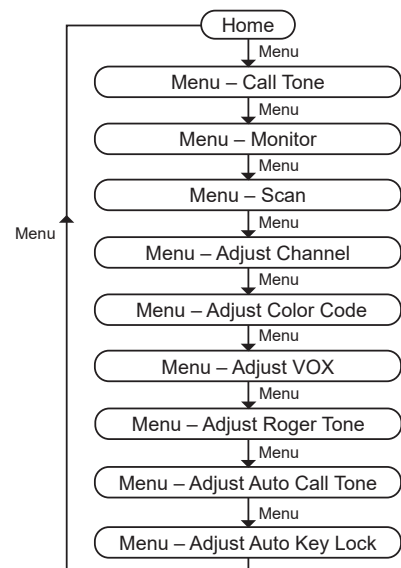

Operations in the Menu Screen

Menu Page	Use the + or - button to perform the following actions:
Call Tone	Start or stop Call Tone transmission.
Monitor MON	Start or stop monitoring the air-wave. You can hear signals transmitted on the channel setting of your radio. If there is no signal, you can hear static.
Scan	Start or stop scanning the air-wave. Radio scans all the channels one after another. When a signal is detected, you hear the signal on the speaker and the radio displays the channel of the detected signal.
Adjust VOX/iVOX VOX/iVOX	To change the Voice Operated Transmission (VOX) setting, select OFF or L1 to L3. L3 is the most sensitive setting for use in quiet environments.
Adjust Roger Tone	Enable or disable the roger tone. Roger tone is a beep tone that you hear when PTT is released.
Adjust Auto Call Tone AUTO	Enable or disable the Auto Call Tone. When enabled, the radio sends a call tone when you press the PTT button to alert receiving radios of incoming messages.
Adjust Channel (Channel number blinks)	Change the radio channel setting.
Adjust Color Code (Code number blinks)	Change the radio code setting.
Adjust Auto Key Lock	Change the Auto Key Lock setting.

Radio Usage

Talking or Transmitting

1. Press and hold the **PTT** button, then start talking into the microphone.
2. Release the **PTT** button to stop transmission.
 - NOTE:** Do not press the **PTT** button when others are talking. When more than one radio transmits on the same channel, the airwave is jammed, and all transmissions are lost.

Listening or Receiving

1. Set the radio to the same channel and code as the transmitting radio for the radio speaker to receive the signal automatically.
2. Ensure that the speaker volume is set to an appropriate level.

Adjusting Speaker Volume

- Press the + or - button from the home screen.

Unlocking Auto Key Lock

- When Auto Key Lock feature is enabled, the **Power/Menu**, **+**, and **-** buttons are locked after 10 seconds of inactivity.
- To unlock the three front buttons, press and hold any of them for two seconds.

Headset Usage

- When a headset is connected to the radio, the radio speaker is disabled. Wear the connected headset to monitor and receive messages.
- If your headset has the PTT button, you can use the button to make a transmission with the microphone on the headset.
- You can still use the PTT button on the radio to make a transmission with the microphone on the radio.

Additional Information

Internal Voice Operated Transmission (iVOX)/Voice Operated Transmission (VOX)

- The microphone detects if you are talking when using iVOX or VOX. If you are talking, the radio triggers the transmission automatically.
- When iVOX is displayed, the radio uses the built-in microphone to detect your voice.
 - When a VOX headset is connected to the radio, VOX is displayed and the headset microphone is used to detect your voice.
- To select the VOX/iVOX sensitivity level, select the following settings:

Level	Descriptions
OFF	Turn off the VOX or iVOX settings.
L3	High Sensitivity for quiet environments. Speaking softly is enough to trigger the VOX or iVOX transmission.
L2	Medium Sensitivity for most environments.
L1	Low Sensitivity for noisy environments. Speak up to trigger the VOX or iVOX transmission.

- NOTE:** Pressing the **PTT** button cancels the VOX or iVOX transmission.

Call Tone

When you send a Call Tone, the receiving radio sounds a tone similar to a phone ringtone. When Auto Call Tone is enabled, a Call Tone is sent automatically when you press the **PTT** button.

Scan

Radio scans for voice activity by cycling through the channels. When signals are detected, the signal is sent to the speaker. Scan feature allows you to find out the channel that is used by other groups and has heavy traffic. Scan

feature helps you to avoid busy channels when deciding the channel to use for your group.

Monitor

You can hear everything including noise on your current radio channel. This feature allows you to monitor a channel for weak signals.

Roger Tone

This feature adds a beep to mark the end of a transmission when you release the **PTT** button. When the receiver hears the roger tone, it is a confirmation that complete message has been received.

Weatherproof Function

This radio is weatherproof to IP-54 standards. The radio is resistant to occasional splash of water only when the battery and connector covers are sealed.

NOTE:

- Do not expose the radio to water for extended period of time.
- Do not submerge the radio in water.

Battery Information

The rated battery life is measured under industrial standard 5-5-90 duty cycle under lab conditions, 5 % of the time transmitting, 5 % receiving with speaker on, 90 % waiting for incoming call.

CAUTION: Use only Motorola Solutions approved batteries. Risk of explosion if the battery is replaced by an incorrect type.

Battery Capacity Maintenance

Batteries should be fully charged before initial use to ensure optimum capacity and performance.

Battery life is determined by several factors. Among the more critical are the regular overcharge of batteries and the average depth of discharge with each cycle. The greater the overcharge and the deeper the average discharge, the fewer cycles a battery lasts. A battery which is overcharged and discharged 100 % several times a day, lasts fewer cycles than a battery that receives less of an overcharge and is discharged to 50 % per day. A battery which receives minimal overcharging and averages only 25 % discharge, lasts longer.

NOTE: Connect the USB charger to a nearby and easily accessible wall power outlet.

CAUTION: Charge only Li-Ion type rechargeable batteries. Other types of batteries may burst, causing personal injury or damage. Turn off radio before charging.

Push-to-Talk Time-Out Timer

To avoid airwave traffic congestion, transmission ends after one minute even if the **PTT** button is still pressed. You can reset the timer by releasing the **PTT** button briefly.

Channels and Frequencies

Channel	Frequency (MHz)	Channel	Frequency (MHz)
1	424.1375	15	448.7750
2	424.1500	16	448.7875
3	424.1625	17	448.8000
4	424.1750	18	448.8125
5	424.1875	19	448.8250
6	424.2000	20	448.8375
7	424.2125	21	448.8500
8	424.2250	22	448.8625
9	424.2375	23	448.8750
10	424.2500	24	448.8875
11	424.2625	25	448.9000
12	448.7375	26	448.9125
13	448.7500	27	448.9250
14	448.7625		

How to Obtain More Information



<https://www.motorolasolutions.com/talkabout>