

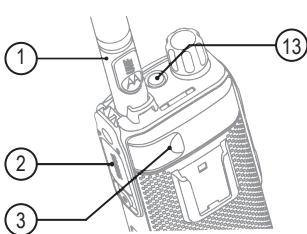

www.motorolasolutions.com

Controls and Indicators



- 1 Antenna
- 2 Side Connector
- 3 External Antenna Connector
- 4 Rotary Knob
- 5 LED Status Indicator
- 6 Programmable Side Button
- 7 Push-To-Talk Button (PTT)

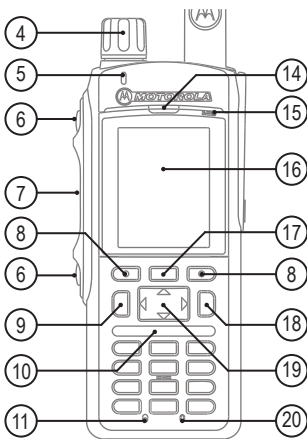

- 8 Soft Keys
- 9 Send Key
- 10 Speaker
- 11 Bottom Microphone
- 12 Bottom Connector
- 13 Emergency Button



- 14 Earpiece
- 15 Top Microphone
- 16 Display
- 17 Menu Key
- 18 On/Off/End/Home Key
- 19 Navigation Key
- 20 Backlight Sensor
- 21 Alphanumeric Keypad

### LED Status Indicator

Indicator	Status	Charging Status
	In use	Fully Charged
	In service	90% Charged
	Out of service	Rapid Charge
	Connecting to a network Entering DMO	Faulty or Invalid Battery
	Transmit Inhibit in service Channel busy in DMO	Not applicable
	Incoming private or phone call	Battery is waiting to charge
	Switched off	Not applicable

### Battery Capacity Information

Information	Description
	Full (80% – 100% capacity)
	Middle (60% – 80% capacity)
	Low (25% – 60% capacity)
	Very low (5% – 25% capacity)
	Less than 5% capacity

### Installing the Battery

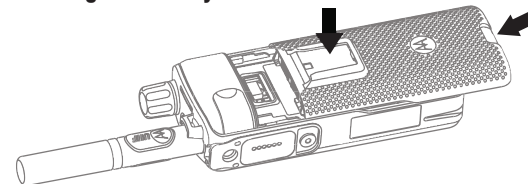

Insert the battery into the compartment.  
Slide the battery towards the top of the radio until it clicks.

### Attaching the Antenna

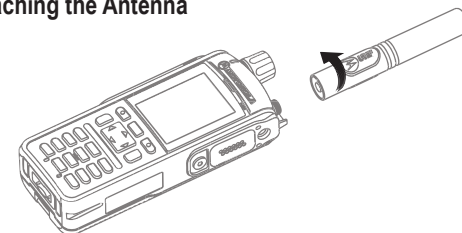

Turn the radio off before attaching the antenna.  
Align the bottom of the antenna and the screw-in base on the top of the radio.  
Turn clockwise until snug. Do not force.

### Unlocking the Radio

Your radio may be locked at power on. To unlock the radio after powering on, enter the code at the prompt.  
The unlock code is set to **0000** by default. Your service provider may change this number before you receive your radio.

### Unlocking/Locking Keys

To unlock/lock the keypad, press the **Menu** key and then the \* key.

### Holding Your Radio

The radio has two microphones:

- A top microphone for Simplex group, dispatcher, or private calls
- A bottom microphone for Duplex, telephone-like calls.

When making Duplex calls (low audio), hold your radio as you would a telephone. Speak into the bottom microphone. Listen via the earpiece. Keep the antenna at least 2.5 centimetres from your head and body.



When making Simplex calls (high audio), hold your radio in a vertical position with the top microphone 5 to 10 centimetres away from your mouth. Speak into the top microphone. Listen via the radio internal speaker. Keep antenna at least 2.5 centimetres from your head and body.



### Looking After Your Radio

Never leave your radio or battery in extreme temperatures (over +85 °C). For example, behind a windscreen in direct sunlight.  
The radio is submersible (compliant with the IP67 standard), but only with the battery and antenna attached.  
To clean your radio, use a moistened or antistatic cloth.

Getting Started

www.motorolasolutions.com

## More Information on the Radio

Visit the Motorola Solutions Web site at:  
<http://www.motorolasolutions.com/>

## Learning Experience Portal

User documentation available at:  
<https://learning.motorolasolutions.com/>

## Open Source Software Legal Notices

Available in Customer Programming Software Plus (CPS Plus) DVD



This document is copyright protected. Duplications for the purpose of the use of Motorola Solutions products are permitted to an appropriate extent. Duplications for other purposes, changes, additions or other processing of this document are not permitted. Only this electronically-saved document is considered to be the original. Duplications are considered merely copies. Motorola Solutions, Inc., and its subsidiaries and affiliates do not vouch for the correctness of such kinds of copies.

MOTOROLA, MOTO, MOTOROLA SOLUTIONS and the Stylized M Logo are trademarks or registered trademarks of Motorola Trademark Holdings, LLC and are used under license. All other trademarks are the property of their respective owners.  
© 2016 and 2021 Motorola Solutions, Inc. All rights reserved.



MN002978A01-AC



## Icons

Icon	Description
	In Service (TMO) standard/extended icon
	No Service (TMO) standard/extended icon
	Signal Strength standard/extended icon
	High RF Power standard/extended icon
	Direct Mode
	Emergency Mode
	Scan
	Battery Level
	Battery Charging
	All Rings Muted
	Simplex Ring Muted
	Duplex Ring Muted
	Bluetooth No/Active Connection

Icon	Description
	Migration
	Low Audio
	High Audio
	Earpiece Connected
	New Message Has Arrived
	New Message(s)
	Packet Data
	Radio Keys Locked
	GPS
	Invalid SD Card
	USB Connected

## Turning the Radio On/Off

To turn the radio on/off, press and hold the **On/Off** key.

## Using the Radio Menu

To enter the menu, press the **Menu** key.  
To scroll through the menu, press the **Up** or **Down Navigation** key.  
To select a menu item, press **Select** or the **Right Navigation** key.  
To return to previous level, press **Back** or the **Left Navigation** key.  
To exit the menu, press the **Home** key.

## Selecting Trunked/Direct Mode Operation

From the home screen, select **Options** and then **Trunked Mode** or **Direct Mode**.

## Making TMO/DMO Group Calls

Enter TMO or DMO. From the home screen, use the **Navigation** keys or **Rotary Knob** to highlight the targeted talkgroup. Press **Select** (if configured). Press and hold **PTT**. Wait for the talk permit tone (if configured) and talk. Release **PTT** to listen.

## Making TMO/DMO Emergency Group Calls

Enter TMO or DMO. Press and hold the **Emergency** button. The emergency alarm is sent automatically (if configured). Press and hold **PTT**. Wait for the talk permit tone (if configured) and talk. Release **PTT** to listen.

If using the Hot Mic feature, wait for the **Emergency Mic On** message to appear on the display, then talk without pressing **PTT**.  
To exit Emergency Mode, press and hold the **Exit** soft key.

## Making Simplex Private Calls

**IN DMO:** From the home screen, dial a number. Press and hold **PTT** to make the call. Wait for the talk permit tone (if configured) and talk. Release **PTT** to listen. Press the **End** key to terminate the call.

**IN TMO:** From the home screen, dial a number. Press and release **PTT** to make the call. Wait for the called party to pick up. Once the call is connected, press and hold **PTT** to talk (wait for the talk permit tone if configured). Release **PTT** to listen. Press the **End** key to terminate the call.

## Making Duplex Private Call/Phone/PABX Calls

From the home screen, dial a number. Press and release the **Send** key. The ring tone sounds. The called party answers. Press the **End** key to terminate the call.

## Sending Status Messages

From the home screen, press the **Menu** key. Select **Messages** → **Send Status**. Perform one of the following actions.

- Highlight the required status message. Press **Select**, the **Send** key, or **PTT**.
- If the status list is empty, enter a 5-digit status message number and press **Send**.